

Features and Benefits

The Floor Mounted Modular Wall Frame compliments perfectly the Molex RAA-0002 or equivalent open bay rack by neatly integrating the fitment of patch cords to patch panels while retaining the required bend radius for optimal performance.

- Fits EIA standard 19" Open Bay Racks
- Allows for upgrading current installations while maintaining current investment in hardware
- Maximises Building Infrastructure
- Excels in space utilisation, by increasing density and freeing up valuable floor space
- Strong & Flexible Poly Carbonate Finger Guides
- Robust but light weight construction holds cables perfectly aligned against each individual patch panel maintain critical bend radii. Smooth edges prevents cable snares and cuts
- Snap Grooved Finger Guides allow easy modification to 2/3 U configuration. With replacements Finger Guides ensures ongoing flexibility for future fit-out requirements
- Cable Retainers click on to the end of finger guides, ideal for holding cables horizontally in place while undertaking maintenance
- A quick lock door allows for fast easy access by allowing instantaneous left or right door opening with flush mounted handles
- Quick Fit Spool which allows easy single handed fit and removal of spools saving time and effort Modular Design
- The design allows flexibility in fit out with additional spools and door kits available

Technical Information

Mechanical Characteristics

Material
Brackets: Cold Rolled Steel

Doors: Aluminium
Spools: ABS
Finger Guides: ABS
Cable Managers: ABS
Cable Retainers: Poly Carbonate

Colour
Brackets & Door: Black Powder Coat
Accessories: Black
Finger Guides: Black
Cable Managers: Black
Cable Retainer: Black

Dimensions (mm) (WxDxH)
12" Bracket: 304.8 x 448.2 x 2079.3
8" Bracket: 203.8 x 448.2 x 2079.3
12" Door: 304.8 x 25.4 x 2079.3
8" Door: 03.8 x 25.4 x 2079.3
1U Horizontal Cable Manager: 482 x 136.6 x 48.9
2U Horizontal Cable Manager: 482 x 136.4 x 89
Spools: 90 x 151.5 x 143.86
Finger Guides: 186.7 x 12.7 x 176.8
12" Cable Retainer: 292.8 x 5.87 x 33.5
8" Cable Retainer: 191.2 x 5.87 x 33.5

Weight (kg)
12" Bracket: 29
8" Bracket: 25.5
12" Door: 3.7
8" Door: 3.0
1U Horizontal Cable Manager: 1.0
2U Horizontal Cable Manager: 1.34
Spools: 0.08
Finger Guides: 0.10
12" Cable Retainer: 0.04
8" Cable Retainer: 0.034

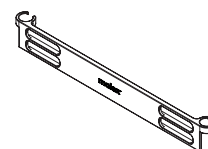
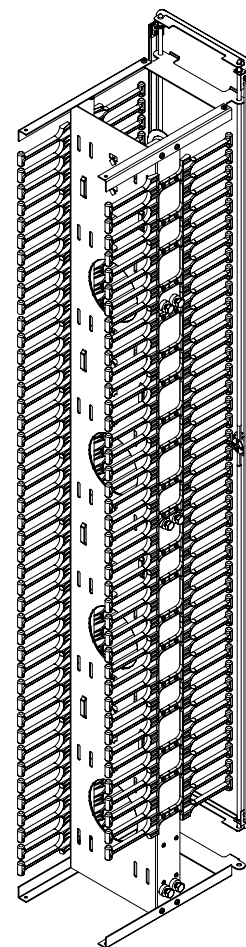

Cable Retainer

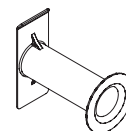

Spool

ORDERING INFORMATION

Order No.	SAP No.	Description
CMA-00083	Consult Molex	12" Floor Mounted Modular Wall Frame - Front/Back & Front Door
CMA-00084	Consult Molex	8" Floor Mounted Modular Wall Frame - Front/Back & Front Door
CMA-00085	Consult Molex	1U Horizontal Cable Manager
CMA-00087	Consult Molex	2U Horizontal Cable Manager
CMA-00088	Consult Molex	12" Vertical Cable Retainer - 5 Pack
CMA-00089	Consult Molex	Spools - 2 Pack
CMA-00090	Consult Molex	Finger Guides - 5 Pack
CMA-00091	Consult Molex	12" Door Kit
CMA-00092	Consult Molex	8" Door Kit
CMA-00096	Consult Molex	8" Vertical Cable Retainer - 5 Pack

MOLEX PREMISE NETWORKS

Americas
Tel: 630 969 4550
www.molexpn.com

EMEA
Tel: 44 (0)2392 205800
www.molexpn.co.uk

APAC
Tel: 61 3 9971 7111
www.molexpn.com.au