

## Features and Benefits

The Floor Mounted Modular Wall Frame compliments perfectly the Molex RAA-0002 or equivalent open bay rack by neatly integrating the fitment of patch cords to patch panels while retaining the required bend radius for optimal performance.

- Fits EIA standard 19" Open Bay Racks
- Allows for upgrading current installations while maintaining current investment in hardware
- Maximises Building Infrastructure
- Excels in space utilisation, by increasing density and freeing up valuable floor space
- Strong & Flexible Poly Carbonate Finger Guides
- Robust but light weight construction holds cables perfectly aligned against each individual patch panel maintain critical bend radii. Smooth edges prevents cable snares and cuts
- Snap Grooved Finger Guides allow easy modification to 2/3 U configuration. With replacements Finger Guides ensures ongoing flexibility for future fit-out requirements
- Cable Retainers click on to the end of finger guides, ideal for holding cables horizontally in place while undertaking maintenance
- A quick lock door allows for fast easy access by allowing instantaneous left or right door opening with flush mounted handles
- Quick Fit Spool which allows easy single handed fit and removal of spools saving time and effort Modular Design
- The design allows flexibility in fit out with additional spools and door kits available

## Technical Information

### Mechanical Characteristics

Material  
Brackets: Cold Rolled Steel

Doors: Aluminium  
Spools: ABS  
Finger Guides: ABS  
Cable Managers: ABS  
Cable Retainers: Poly Carbonate

Colour  
Brackets & Door: Black Powder Coat  
Accessories: Black  
Finger Guides: Black  
Cable Managers: Black  
Cable Retainer: Black

Dimensions (mm) (WxDxH)  
12" Bracket: 304.8 x 448.2 x 2079.3  
8" Bracket: 203.8 x 448.2 x 2079.3  
12" Door: 304.8 x 25.4 x 2079.3  
8" Door: 03.8 x 25.4 x 2079.3  
1U Horizontal Cable Manager: 482 x 136.6 x 48.9  
2U Horizontal Cable Manager: 482 x 136.4 x 89  
Spools: 90 x 151.5 x 143.86  
Finger Guides: 186.7 x 12.7 x 176.8  
12" Cable Retainer: 292.8 x 5.87 x 33.5  
8" Cable Retainer: 191.2 x 5.87 x 33.5

Weight (kg)  
12" Bracket: 29  
8" Bracket: 25.5  
12" Door: 3.7  
8" Door: 3.0  
1U Horizontal Cable Manager: 1.0  
2U Horizontal Cable Manager: 1.34  
Spools: 0.08  
Finger Guides: 0.10  
12" Cable Retainer: 0.04  
8" Cable Retainer: 0.034

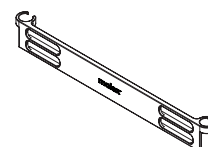
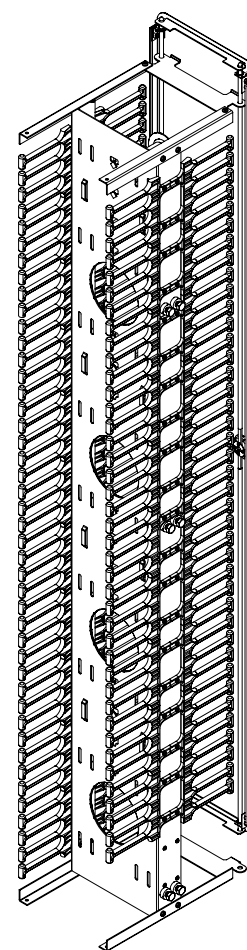

Cable Retainer

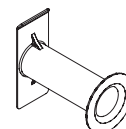

Spool

## ORDERING INFORMATION

Order No.	SAP No.	Description
CMA-00083	Consult Molex	12" Floor Mounted Modular Wall Frame - Front/Back & Front Door
CMA-00084	Consult Molex	8" Floor Mounted Modular Wall Frame - Front/Back & Front Door
CMA-00085	Consult Molex	1U Horizontal Cable Manager
CMA-00087	Consult Molex	2U Horizontal Cable Manager
CMA-00088	Consult Molex	12" Vertical Cable Retainer - 5 Pack
CMA-00089	Consult Molex	Spools - 2 Pack
CMA-00090	Consult Molex	Finger Guides - 5 Pack
CMA-00091	Consult Molex	12" Door Kit
CMA-00092	Consult Molex	8" Door Kit
CMA-00096	Consult Molex	8" Vertical Cable Retainer - 5 Pack

## MOLEX PREMISE NETWORKS

**Americas**  
Tel: 630 969 4550  
www.molexpn.com

**EMEA**  
Tel: 44 (0)2392 205800  
www.molexpn.co.uk

**APAC**  
Tel: 61 3 9971 7111  
www.molexpn.com.au